

Fixed and Wire Suspended Exit Sign Range

MexLITE Range

The **MexLITE** range of high quality LED exit sign luminaires is perfectly suited to modern architectural environments and available in two sizes for 25m and 30m viewing distances.

Offering ease of installation, these luminaires feature a first fix plate. The attractive slim body and legend plate then clips into position.

The safety sign legends can be fitted/changed on site by simply clipping the appropriate sign into the frame.

(NB: a complete set of EC & ISO legends are supplied with each luminaire).

The framed panel has a specially screen printed finish to ensure uniform illumination of the safety sign legend.

Due to their slim design and different mounting options, **MexLITE** luminaires are ideal for integrating into new and existing installations.

The **MexLITE ESA09** and **ESA11** can have the legend panel suspended at different levels by just slipping the wires through the locking clutch bushes. The SELV supply to the LEDs is fed through the suspension wires.

OPERATION

The **MexLITE** luminaires are available with mains only or Maintained emergency operation. (All emergency versions provide 3 hour duration). Maintained versions can be used for standard switched mains lighting but will automatically provide emergency lighting in the event of a complete loss of normal mains supply. (Non-maintained operation is available by excluding a switched live supply).

MexLITE luminaires use the latest high efficiency, white LEDs, a 'smart' energy efficient battery charger/driver circuit and long-life Lithium Iron Phosphate batteries (LiFePO₄).

NOTE: **MexLITE** luminaires can be equipped with **SurePath BLE** Bluetooth addressable Gateway modules. [See Data Sheet.](#)

The luminaires are designed to fully comply with the relevant parts of EN60598.2.22

DALI/Self-Test Options:

The **MexLITE** luminaires can be specified with integral DALI/Self-Test gear providing automatic Self-Test in accordance with BSEN62034 or fully interoperable DALI operation when connected to a DALI control system.

NB: Self-Test is available for all versions but DALI operation is only available for the larger sizes — **ESA10 & ESA11**.



GENERAL DETAILS

Product	LED Exit Sign (Fixed and Wire Suspended)
Light source	PCB mounted white LEDs
Sign viewing distances	25m (ESA08 and ESA09) 30m (ESA10 and ESA11)
Construction	Polycarbonate
Geartray	First fix plate
Dimensions	See line drawings
Cable entry	Top and back (first fix plate)



MXL/ESA08 and MXL/ESA10



Adjustable suspension wire
Length: 15mm to 1metre

MXL/ESA09 and MXL/ESA11

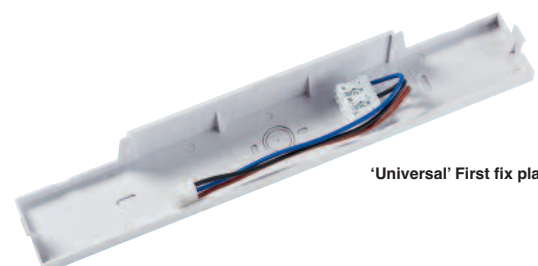

'Universal' First fix plate

All details and specifications shown in this document are deemed correct at time of publication. The right to modify equipment, change specifications and instructions without notice, is reserved as part of the Emergency Lighting Products Limited policy of continuous development and improvement. We endeavour to keep all our customers informed of any alterations as and when they occur.



Fixed and Wire Suspended Exit Sign Range

SPECIFICATION

Light source	PCB mounted white LEDs
Colour temperature	4500K
Luminaire Lumens	N/A
IP Rating	IP40
Ambient temperature (Ta)	0° to 45°C
Insulation Class	Class II
Supply voltage	230V ~ 50Hz
Supply power (Maintained)	3.1W (ESA 08/09) 4W (ESA 10/11)
Supply power (Non-maintained)	0.8W
Charge power (typical)	0.7W
Battery (LiFePO4)	6.4V 600mAh (standard) 3.2V 3.2Ah (DALI)
Weight	2.5kg (max.)



MXL/ESA09/LFP (small) MXL/ESA11/LFP (large)



Simple height adjustment

Wall/Ceiling Mounting with optional Wire Suspension

MexLITE Exit Signs are suitable for Wall/Ceiling mounting and offer Wire Suspended versions.

Mounting is achieved via a first fix plate which has fixing holes suitable for wall or ceiling mounting.

The Wire Suspended versions utilise parallel suspension wires that allow the height of the legend to be easily set by the use of two locking clutch bush mechanisms.

Recessed Mounting

MexLITE Exit Signs can be supplied with a ceiling recessing accessory allowing a standard body to recess into a ceiling cut-out mounting bracket.

This feature is ideal for applications requiring a more aesthetic installation.



MXL/ESA11/LFP/RB (using /RB recessing accessory)

Fixed and Wire Suspended Exit Sign Range

DIMENSIONS

The two styles of **MexLITE** (fixed and wire suspended) are both available in two different sizes, providing viewing distances of 25 metres and 30 metres.

Large = 30m viewing distance

Small = 25m viewing distance

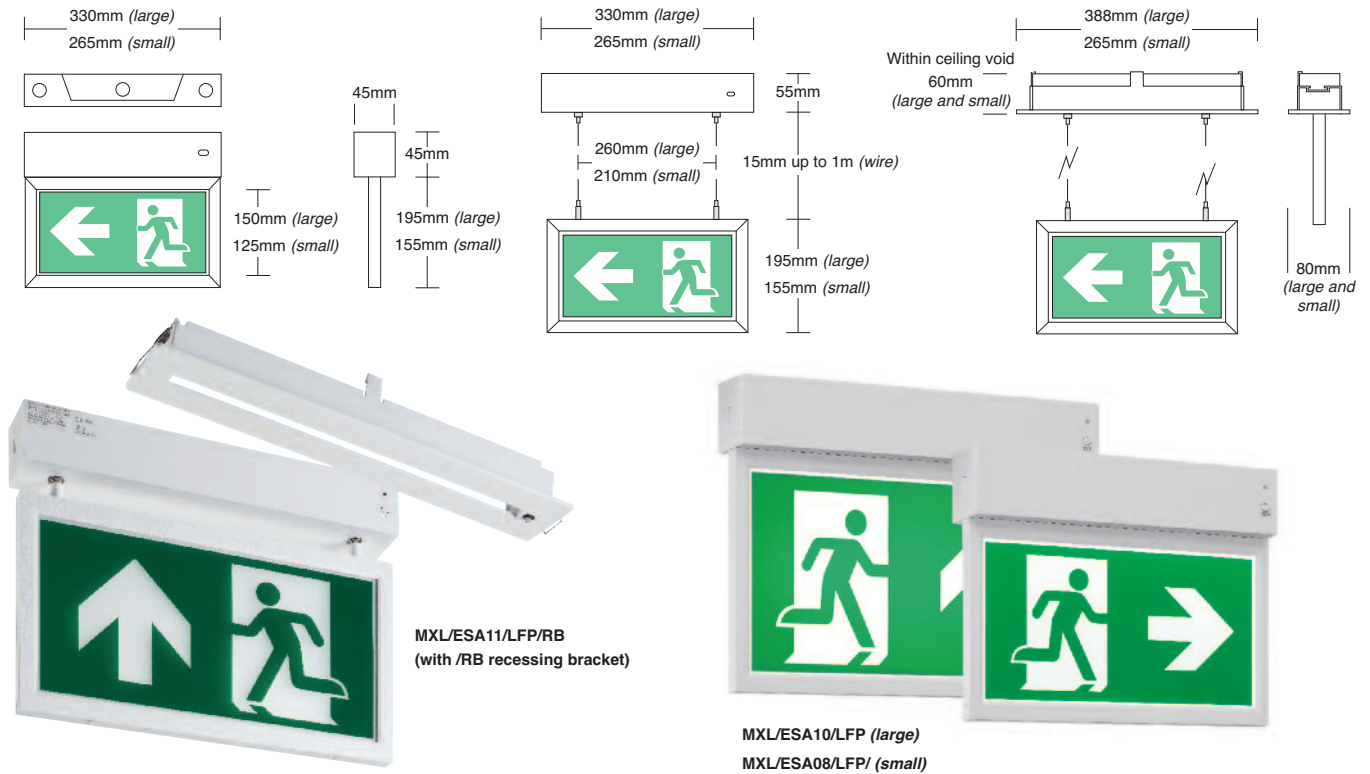

ORDER CODES

Description

25m viewing distance

MXL/ESA08/LFP	Wall/Ceiling Mounted, 3 hour duration, Maintained, Non-Maintained
MXL/ESA08/230	Wall/Ceiling Mounted, Mains only
MXL/ESA09/LFP	Wall/Surface Mounted Wire Suspended, 3 hour duration, Maintained, Non-Maintained
MXL/ESA09/230	Wall/Surface Mounted Wire Suspended, Mains only

NB: All versions supplied with a complete set EC and ISO legend screens

30m viewing distance

MXL/ESA10/LFP	Wall/Ceiling Mounted, 3 hour duration, Maintained, Non-Maintained
MXL/ESA10/DA/LFP	Wall/Ceiling Mounted, 3 hour duration, DALI Maintained, Non-Maintained
MXL/ESA10/230	Wall/Ceiling Mounted, Mains only
MXL/ESA11/LFP	Surface Mounted Wire Suspended, 3 hour duration, Maintained, Non-Maintained
MXL/ESA11/DA/LFP	Surface Mounted Wire Suspended, 3 hour duration, DALI Maintained, Non-Maintained
MXL/ESA11/230	Surface Mounted Wire Suspended, Mains only

NB: All versions supplied with a complete set EC and ISO legend screens

OPTIONS:

/ST	Self-Test emergency operation (no DALI operation)
MXL/ESA08-09/RB	Recessing bracket for recessed ceiling applications (For MXL/ESA08 and 09 versions)
MXL/ESA10-11/RB	Recessing bracket for recessed ceiling applications (For MXL/ESA10 and 11 versions)

ADDITIONAL LEGENDS:

MXL/ESA08-09/ISO/**	MXL/ESA08 or 09	Single	ISO format legend panel
MXL/ESA08-09/EC/**	MXL/ESA08 or 09	Single	EC format legend panel
MXL/ESA10-11/ISO/**	MXL/ESA10 or 11	Single	ISO format legend panel
MXL/ESA10-11/EC/**	MXL/ESA10 or 11	Single	EC format legend panel

** = Add suffix **AR**-right or **AL**-left or **AD**-down or **AU**-up

Emergency Lighting Products Limited

Parbrook House, Gillmans Industrial Estate, Natts Lane Billingshurst, West Sussex RH14 9EZ
 Telephone: +44 (0) 1403 786601 Fax: +44 (0) 1403 786602 e-mail:sales@elp.uk.com www.elp.uk.com

